



Transit Service During Confederation Line Construction

Updates for 2016

February 10, 2016

Background

Transitway Closure Timelines:

- ✓ June 2013 – Laurier / Nicholas Realignment;
- ✓ December 2014 – Booth Street at LeBreton Station;
- ✓ June 2015 – Hurdman Station to Blair Station;
- ✓ December 2015 – Lees Station to Hurdman Station;
- ✓ January 2016 – Merton Street to Empress Avenue;
- **March 2016 – Tunney's Pasture Station Ramp;**
- **April 2016 – Laurier Avenue to Lees Avenue; and,**
- **June 2016 – Tunney's Pasture Station to Merton Street.**



March 2016

TUNNEY'S PASTURE TRANSITWAY RAMP

2



Tunney's Pasture Station Transitway Ramp Closure

- The ramp to/from the Transitway at Tunney's Pasture Station will be closed from March 2016 until June 2016 to facilitate construction of the end-state Tunney's Pasture Station bus facilities;
- Tunney's Pasture Station will remain open;
- Routes 86 and 176 will be detoured via Scott Street; and,
- No additional travel time for customers, under normal traffic conditions.



Tunney's Pasture Station Transitway Ramp Closure



April 24, 2016

LAURIER TO LEES

2



Laurier to Lees

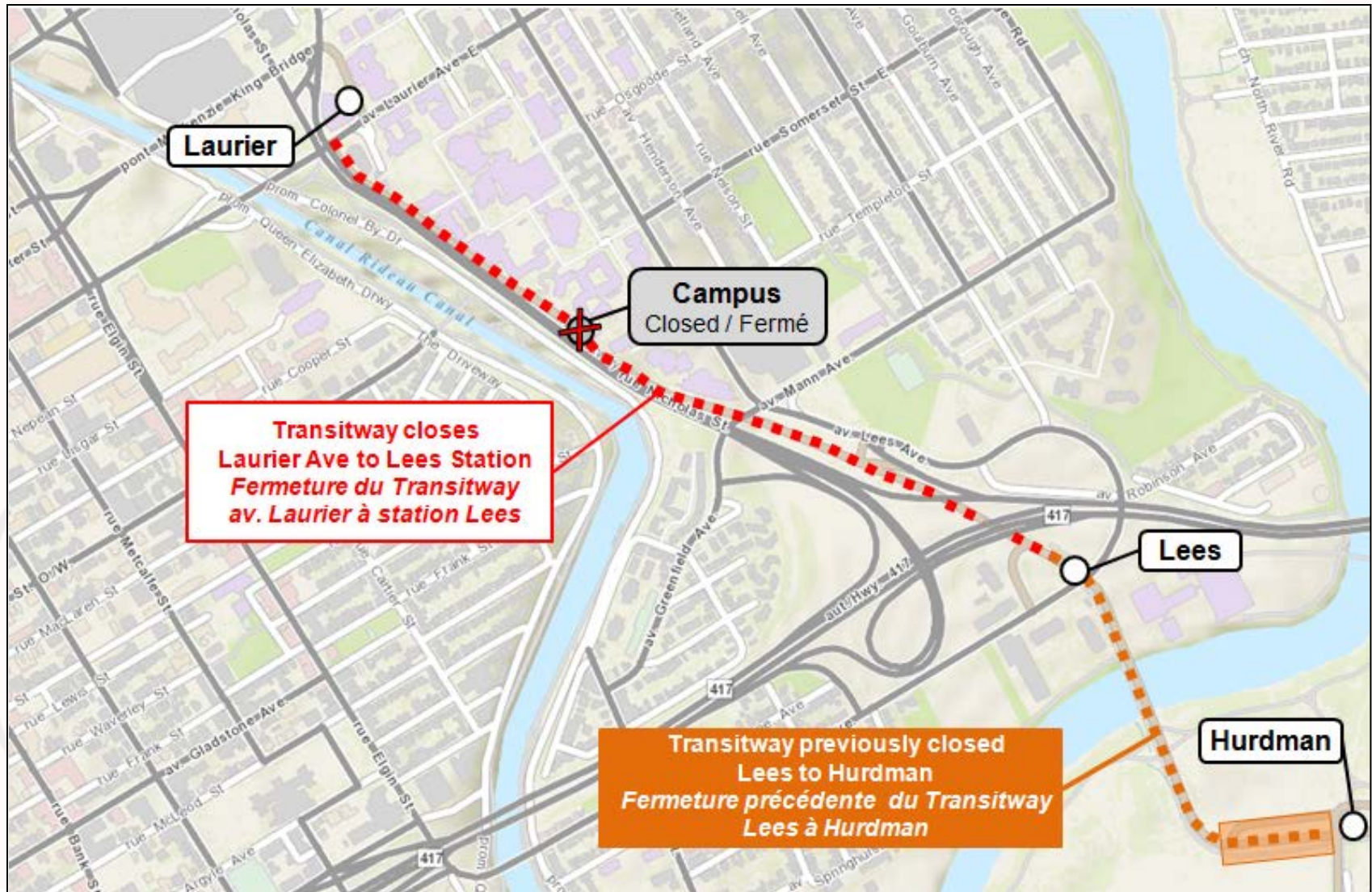

Service adjustments with Transitway closure

- Transitway closes between Laurier Avenue and Lees Station;
- Campus Station will be closed;
- Most bus service between Laurier Avenue and Lees Station will use Nicholas St;
- Routes 85, 95 and 98 will use King Edward Avenue and Laurier Avenue to maintain good transit connections for Sandy Hill and uOttawa main campus;
- All west-end express trips in the afternoon will start at Mackenzie King Bridge; and,
- O-Train Trillium Line will be faster for customers travelling from the southeast to points west of Bank Street.



Services via Nicholas Street

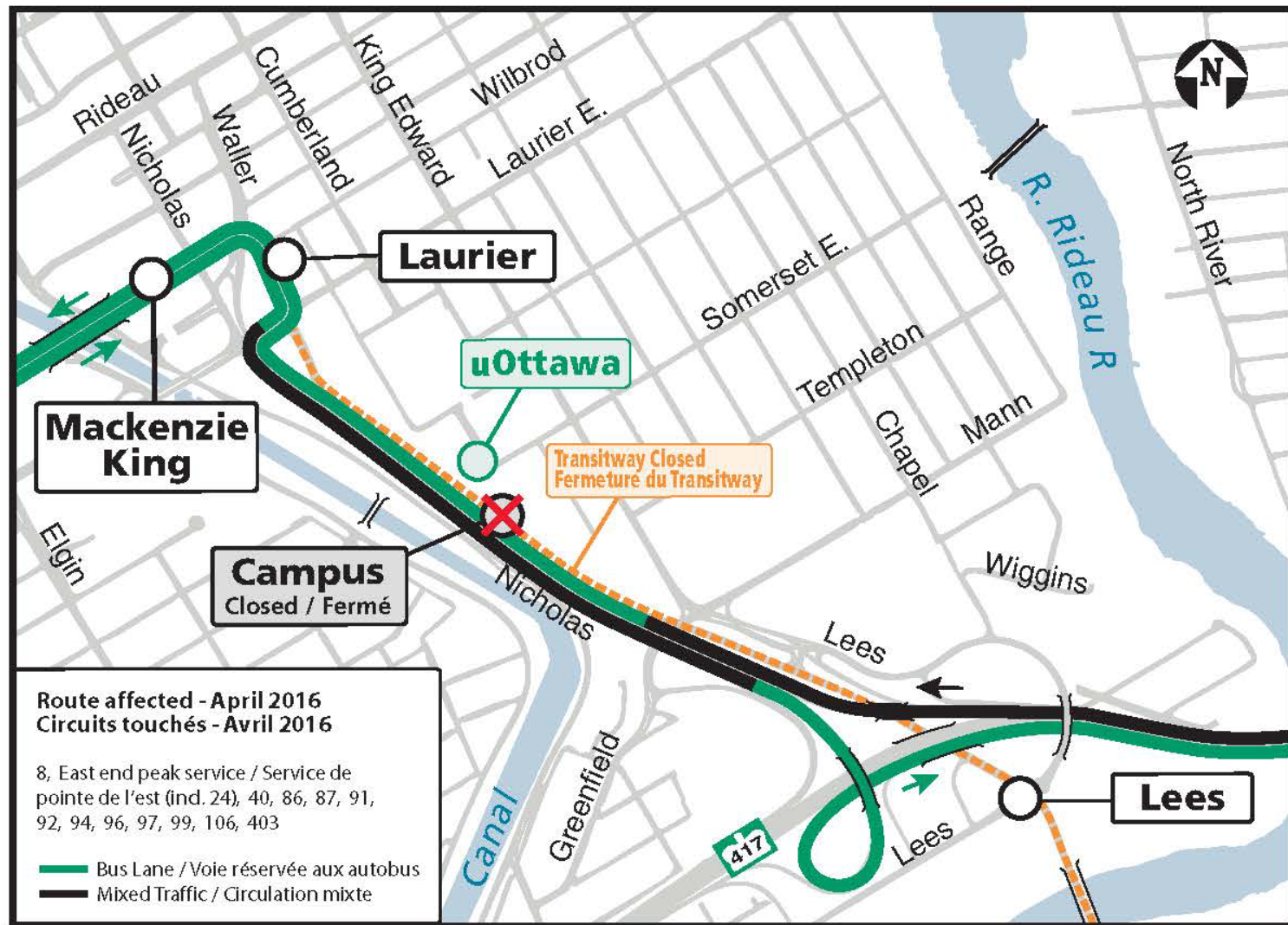



Walking Distances at uOttawa

To/from Laurier Station

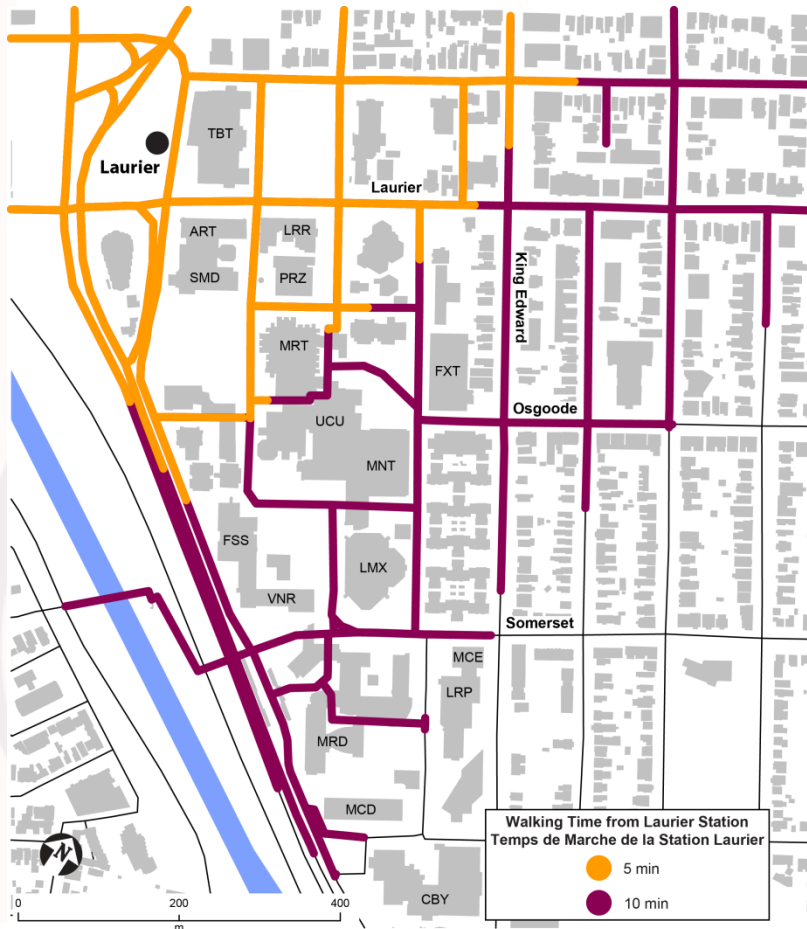

To/from All Services

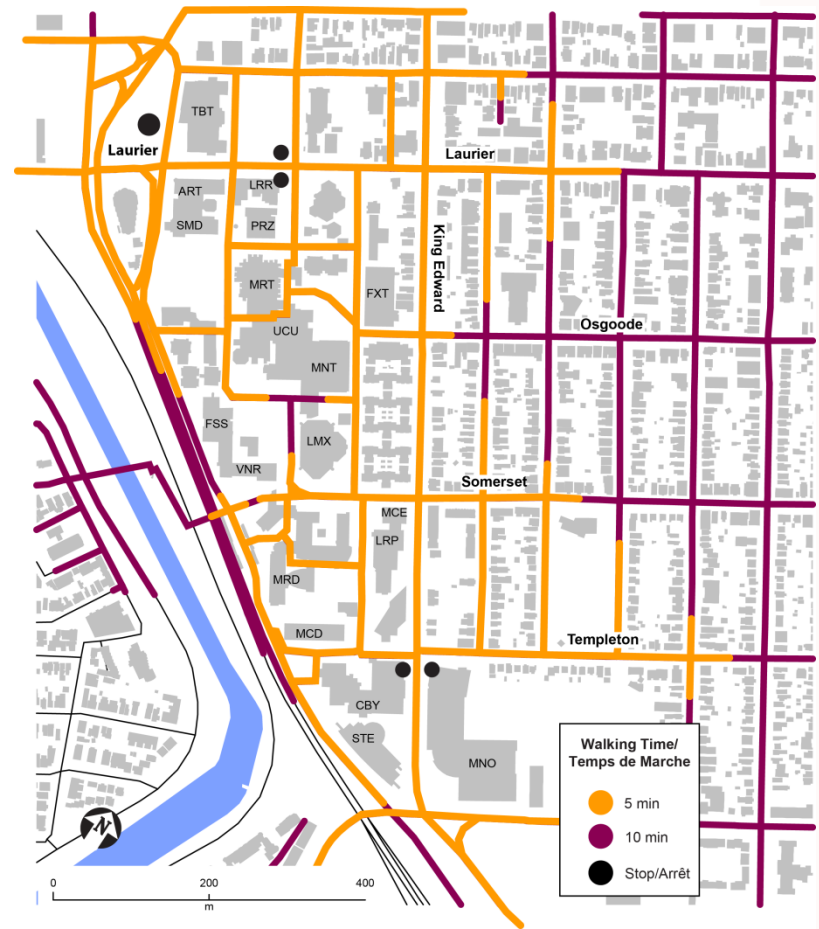

How Will Customers Be Affected?

Laurier Avenue to Lees Avenue Closure

- Of the 340,000 network-wide typical daily customer-trips:
 - Travel times to downtown will remain the same for 94% of customers; and,
 - 6% will have a longer travel time of one to four minutes.

2



Summary of Route Changes

Route	Change	Change to Travel Time
East/southeast peak period routes 20, 21, 22, 24, 27, 30, 31, 34, 35, 37, 38, 40, 221, 231, 232	via Nicholas St	Risk of delay when highway not moving well
8, 86, 87, 91, 92, 94, 96, 97, 99	via Nicholas St	Risk of delay when highway not moving well
95, 98	via King Edward Ave	1 to 4 min longer
West/southwest peak period routes 60, 61, 62, 64, 65, 66, 67, 68, 69, 70, 71, 72, 73, 77, 176, 261, 262, 263, 283	Afternoon trips start at Mackenzie King Bridge	No change



June 19, 2016

TUNNEY'S PASTURE TO MERTON

2



Tunney's Pasture Station to Merton Street

- Transitway closes from Tunney's Pasture Station to Merton Street
 - New Transitway ramp opens to connect the Transitway to Tunney's Pasture Station upper level;
 - Lower level of Tunney's Pasture Station will be closed; and,
- Buses will operate via Scott Street between Tunney's Pasture Station and Merton Street
 - One minute of additional travel time required, under normal traffic conditions.



Tunney's Pasture Station to Merton Street

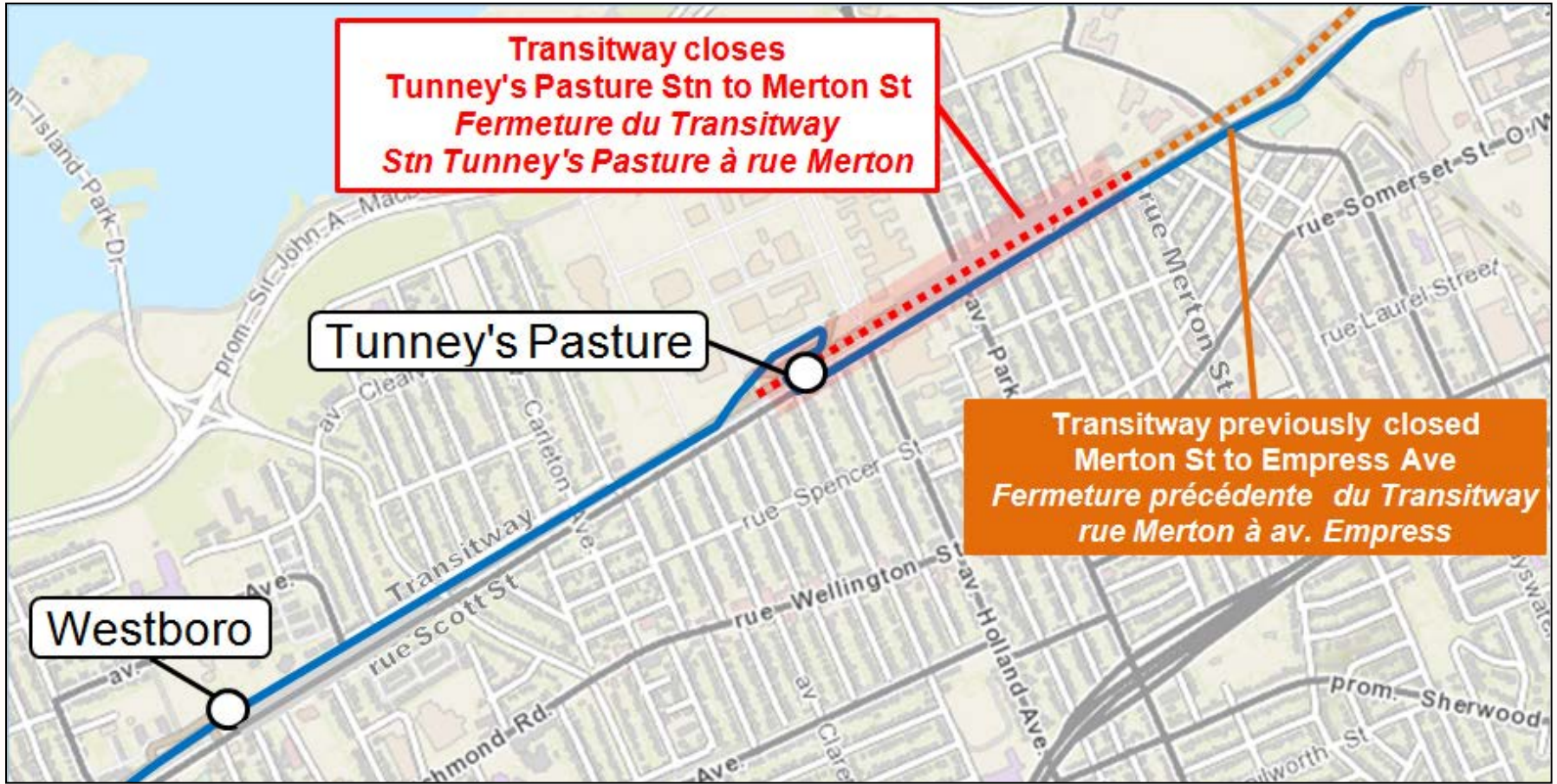

Tunney's Pasture Station During Construction

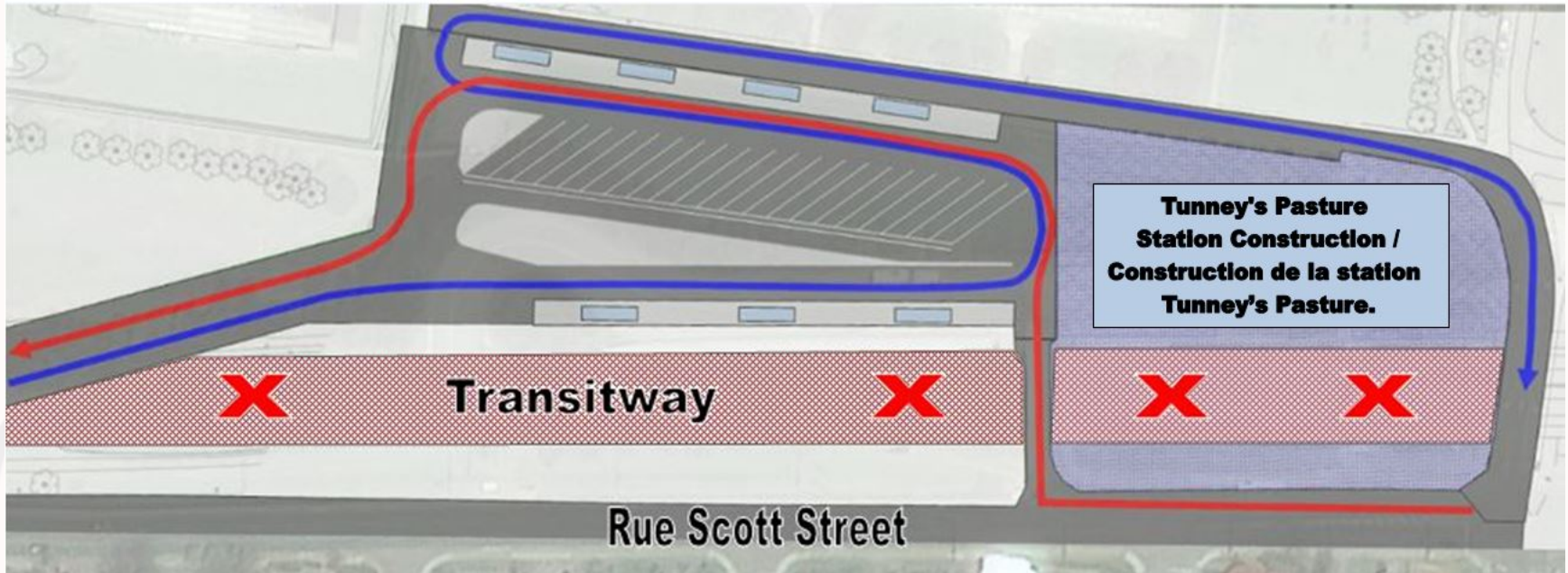

2



How Will Customers Be Affected?

Tunney's Pasture Station to Merton Street closure

- Of the 340,000 network-wide typical daily customer-trips:
 - 14% of customers will have a longer travel time of approximately one minute.

2



Summary of Route Changes

Route	Change	Change to Travel Time
West/southwest peak period routes 60, 61, 62, 64, 65, 66, 67, 68, 69, 70, 71, 72, 73, 77, 105, 176, 261, 262, 263, 283	via Scott St	1 min longer
86, 87, 91, 92, 94, 95, 96, 97, 98	via Scott St	1 min longer
150, 151, 159	No change	No change



September 4, 2016

HURDMAN STATION RELOCATION

2



Hurdman Station Relocation

- The end-state bus facilities will be complete;
- Bus service will serve the new platform; and,
- Construction will continue on other parts of the station.



Hurdman Station During Construction

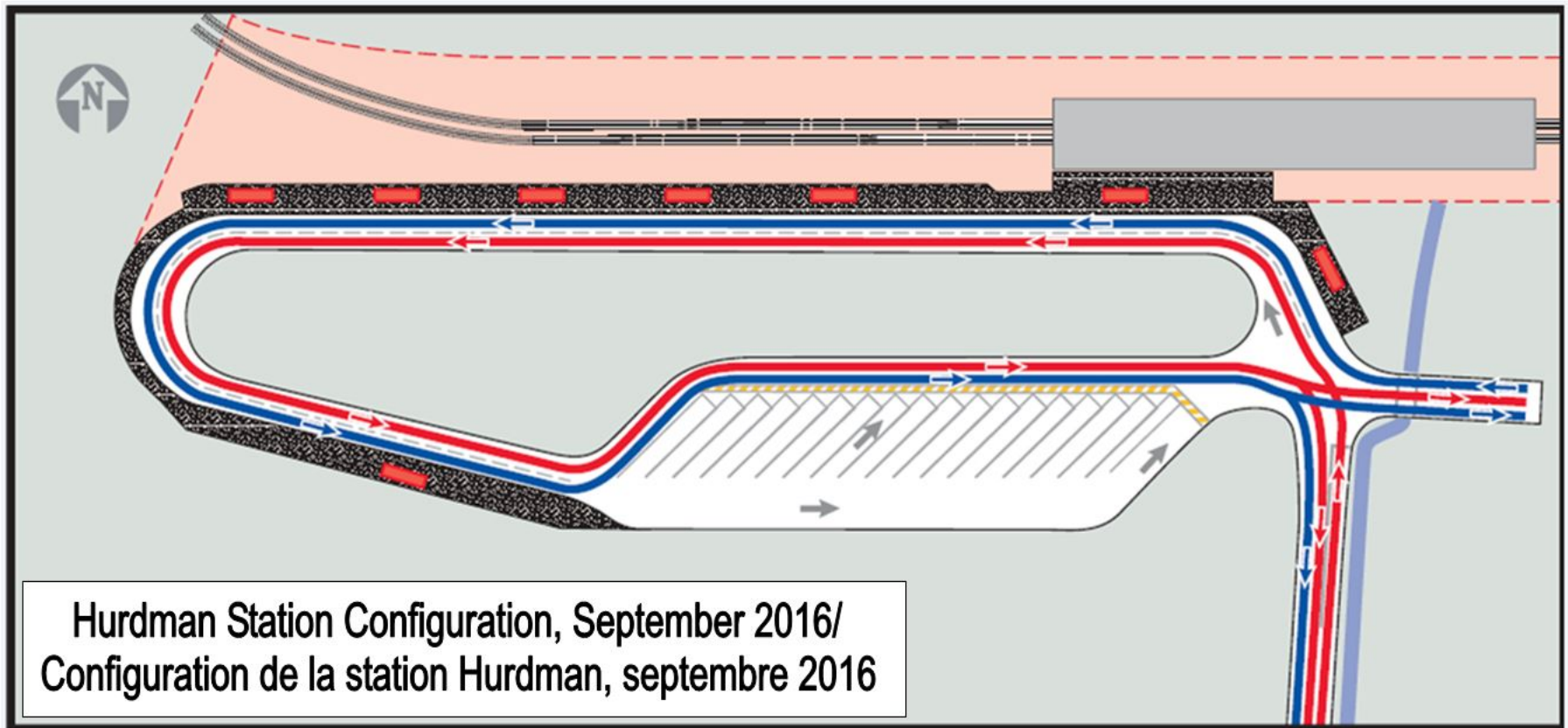

2



SUMMARY OF TRANSIT SERVICE ADJUSTMENTS

2



Transit Service Adjustments

- March – Tunney's Pasture Station ramp;
- April 24 – Laurier Avenue to Lees Station;
- June 19 – Tunney's Pasture Station to Merton Street; and,
- September 4 – Hurdman Station.



On Track for 2018!

- With these service adjustments the Transitway between Tunney's Pasture and Blair Stations will be fully closed to allow for the construction of the Confederation Line.
- These service adjustments will remain in effect until the opening of the Confederation Line in 2018.



Delay / Incident Management

- Stakeholders are continuing to meet regularly to mitigate delay / incidents:
 - OC Transpo;
 - Public Works (Traffic Management, Traffic Operations);
 - Rail Implementation Office;
 - Ottawa Police Service;
 - Ontario Provincial Police; and,
 - Ontario Ministry of Transportation.



Information for Customers

Key Messages:

- Changes will occur in March, April and June that may affect your travel;
- Use the Travel Planner at octranspo.com to plan your trips; and,
- O-Train Trillium Line a good choice for many customers.

Principles:

- Create awareness of the changes;
- Reach people where it counts; and,
- Convey the long-term benefits resulting from the conversion to light rail.



Many Information Channels

- Posted information at stations and shelter posters;
- System map;
- Pamphlets on-board buses;
- Customer interaction at Sales and Information Centres;
- Outreach at stations and key destinations, supported by social media;
- Onboard audio announcements;
- OC Transpo customer contact centre;
- octranspo.com and ottawa.ca;
- Employer/destination e-mail networks;
- Radio ads; and,
- Local and regional newspaper ads.

2









2





Questions?

2

